

N.B. - **PUDLO Surface Sealer** to be applied across both wall and floor in line with TDS prior to installation of **PUDLO Cavity Drain System**.

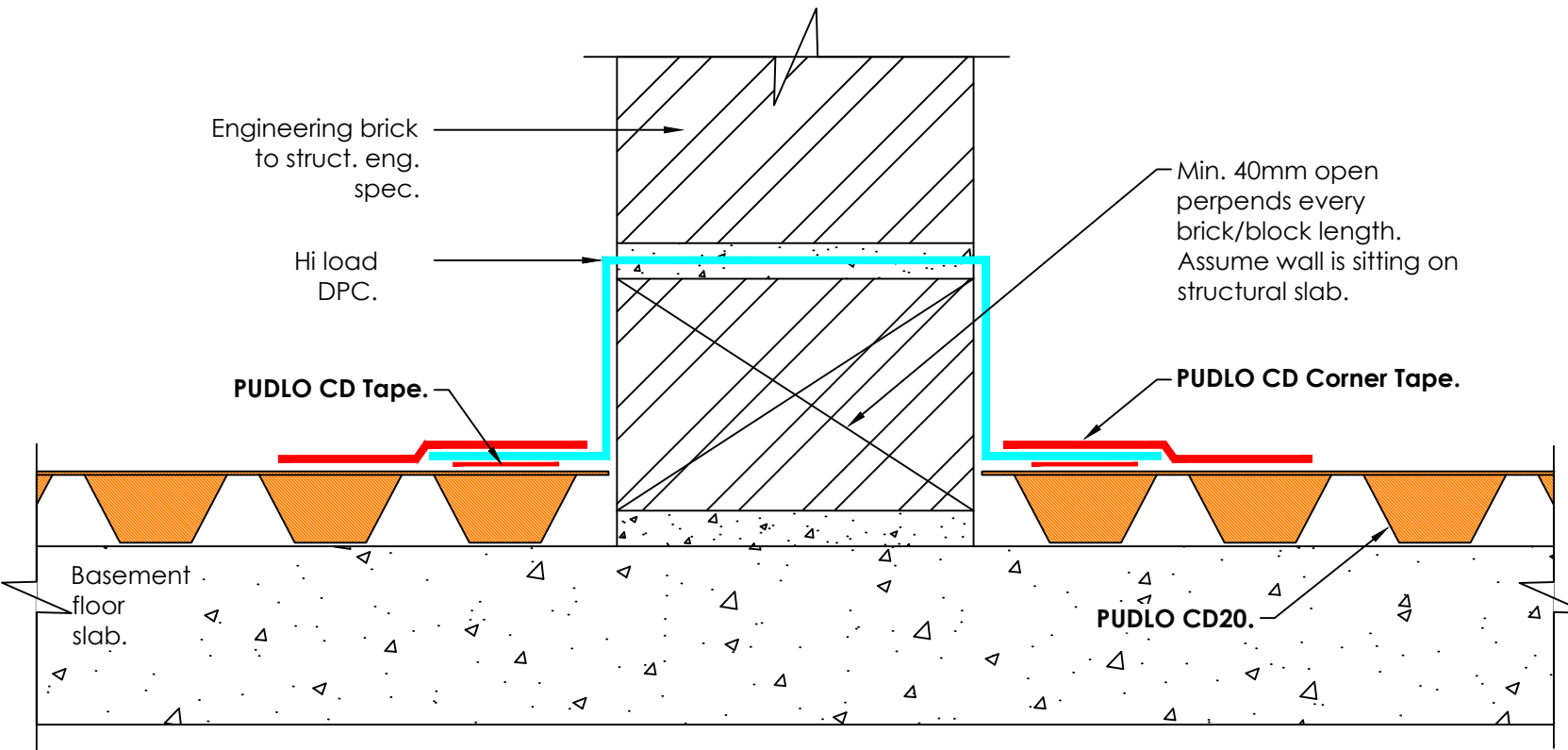

Part of the DB Group

Revision History

DATE	DESCRIPTION	REV.	DES.	Q.C.
16/04/19	Updated to January 2019 design standards.	B	HR	LL
27/09/18	Updated to September 2018 design standards.	A	LD	LL
28/06/18	First issue.	-	LD	LL

DB Group (Holdings) Ltd
 Wellington Way, Bourn Airfield
 Cambridge, CB23 2TQ
 Tel: +44 (0)1954 780687 Email: sales@pudlo.com
 www.dbgholdings.com/pudlo

DRAWING TITLE CONTINUITY THROUGH INTERNAL WALL DETAIL	PROJECT (project name)		
STATUS FOR INFO	SCALE 1:2 on A4		
DRAWING NUMBER PUDLO-TJD-CDS-001b	REVISION B	SHEET No. 1 of 1	
CLIENT (client)			

COPYRIGHT: Not to be reproduced without written permission

A4

PUDLO/DB Group
 STD Oct 2018 v1

Note:-

This PUDLO detail is to assist with the installation of its products. The detail shows how PUDLO CWP Modified Concrete and how PUDLO ancillaries are to be installed. For site specific details and confirmation on extent of where PUDLO CWP Modified Concrete is used i.e. Overlay drawings, must be confirmed by structural engineers/contractor. Individual/Company responsibility for design of the structure must ensure that details shown on PUDLO drawings match the latest construction issue drawings.

The information shown on this detail is given without obligation, or warranty **PRIOR** to consultation or communication with PUDLO/BD Group Ltd.